

**LABELS, PRINTERS & SOFTWARE FOR THE LAB**  
**LABORATORY I.D.**  
[WWW.BRADYID.COM/LAB](http://WWW.BRADYID.COM/LAB)



## Simplify Your Laboratory Identification

Brady's line of laboratory identification products are designed for sample identification applications in life science, biotechnology, and forensic research, as well as patient sample labelling in healthcare. Brady products meet four current labelling challenges associated with sample tracking:

1. Labels sized to existing vial, slide, and well plate sizes.
2. Labels that can be easily read by people or scanners, every time.
3. Labels that withstand extreme conditions including freezer storage, liquid nitrogen, autoclave, and hot water baths. Labels are resistant to solvents including Xylene, DMSO, and Ethanol.
4. Barcoding capabilities - linear (C39, C128) or, 2D codes (data matrix and more) that allow user to include more information on the sample and reduce human error

### HAND-WRITTEN VERSUS PRINTED LABELS



#### Hand-Written Labels

- Hand-written information difficult to read
- Ink smears easily when handled
- Limited write-on area
- Time consuming
- Ink fades while stored long term
- Chemicals and solvents wash away ink
- Prone to human error



#### Brady Printed Labels

- Ink and barcodes won't smear or fade
- Crisp, clear, readable text and barcodes
- More information fits on label
- Quickly and easily design and print labels (auto serialize)
- Increased legibility/durability
- Superior chemical and solvent resistance

### BRADY LAB-DURABLE LABELS



Brady's special **B-461 self-laminating** or wrap around label protects your label's legend from extreme temperature, chemicals, and solvents.

- Printing is crisp and clear so it's readable every time
- Clear portion wraps around vials and secures to itself leaving a window to view the sample contents
- Low profile label resists jamming in centrifuge or racks
- Labels withstand liquid nitrogen (-196°C), freezer (-80°C), autoclave (+121°C), and chemicals like Xylene, DMSO, ethanol and alcohol.
- Labels can withstand multiple freezer-thaw cycles

*\*For best adhesion, we recommend that you do not touch the adhesive side of the label when wrapping it around your vial or tube.*

## FreezerBondz™ Labels

FreezerBondz labels withstand environments from LN2 to autoclave, helping preserve your research while maintaining sample traceability.

Sample # 715  
FREEZER BONDZ  
AJG 6-22-01

## Laboratory Identification Applications

### Vial Top Identification

X-82-499



### Well Plate Identification

THT-15-488

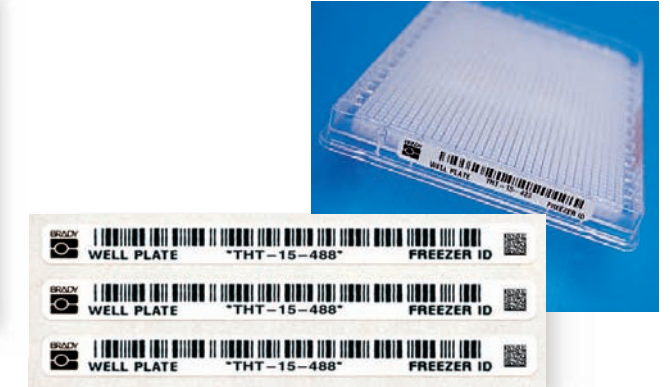

### Slide Identification

X-97-488



### Cryovial and Tube Identification

XSL-75-461



### Centrifuge Tube Identification

XSL-126-461

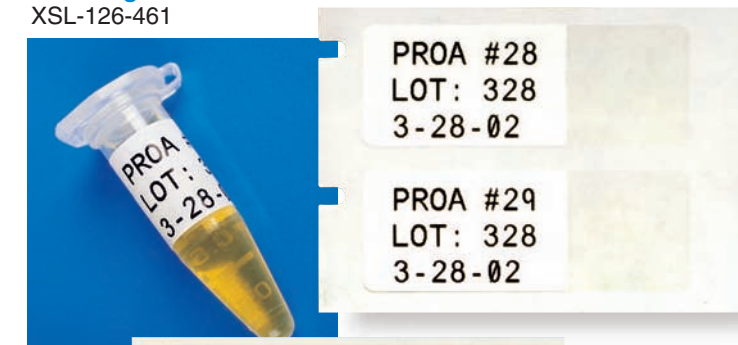

### Glass Flask Identification

X-78-499

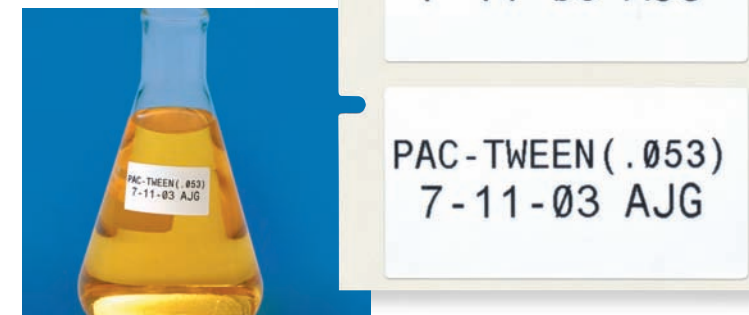

### PCR Tube Identification

XSL-108-461

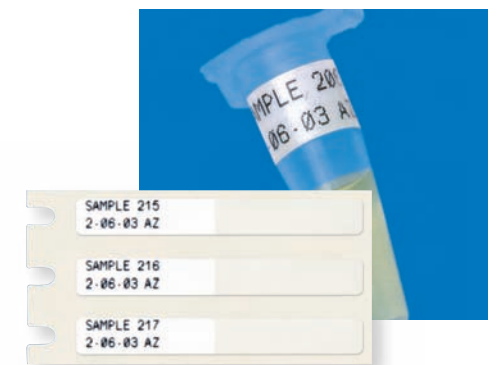

## Laboratory Label Materials Chart

- |   |                                 |
|---|---------------------------------|
| <b>F</b> Slide Staining Process             | <b>V</b> Vial identification    |
| <b>F</b> Freezer environment                | <b>S</b> Slide identification   |
| <b>N</b> Liquid nitrogen environment        | <b>P</b> Plate identification   |
| <b>A</b> Autoclave environment              | <b>G</b> General identification |
| <b>H</b> Hot water (100°C) bath             |                                 |
| <b>S</b> Self-laminating label              |                                 |
| <b>L</b> Low-profile (extremely thin) label |                                 |
| <b>R</b> Removable/Repositionable           |                                 |



Brady Material Number	Application	Special Properties	Print Method	TLS Ribbon	THT Ribbon Series	Temperature Range °C
<b>NYLON CLOTH</b>						
B-499	Vials, tubes, plates, bottles, and general laboratory identification	Permanent adhesive; write-on capabilities, easy handling	FNA	V PG	R4310	R4300 R6000 R4500
B-799	Vials, tubes, plates, bottles, and general laboratory identification	Permanent adhesive; write-on capabilities, easy handling	FNA	V PG	-	-
<b>VINYL CLOTH</b>						
B-498	Vial, slides, plates, bottles, and general lab ID, post process tissue cassettes	Removable from flat surfaces; write-on capabilities			R6210	R6200
<b>POLYESTER</b>						
B-361	Vials and slides	Permanent adhesive; suitable if label material is wrapped around itself, as in self-lamination	FNAHSL	V	-	-
B-461	Vials and slides	Permanent adhesive; suitable for liquid nitrogen application if label material is wrapped around itself, as in self-lamination	FNAHSL	VS	R4310	R4300
B-423	Plates, glass bottles, & general laboratory identification	Permanent acrylic adhesive; ideal for flat surfaces	F A		PG	R6010 R4410
B-430		Glossy clear polyester				R6010
B-432		Glossy clear polyester				R6010
B-481	Slides and General Laboratory Applications	Super chemical resistant polyester ideal for slide staining process	FN		SG	R6410
B-488	Vials, slides, plates, bottles, and general lab ID	Permanent acrylic adhesive; ideal for flat surfaces; write-on capabilities; excellent solvent resistance and xylene resistance. Material must slightly overlap itself	F A		SPG	R4310
B-490	Vials, bottles, plates, plastic, or cardboard boxes	Label material that will adhere to frozen surfaces. Material must slightly overlap itself	FNAHL	V PG	R4310	R4300
B-492	Vials, plates, slides, straws, plastic and cardboard boxes, bags	Label material that will adhere to frozen surfaces	FNAHL	V PG	R4310	R6400
B-709	Plates, glassware bottles, and general lab ID	Removable from flat surfaces; write-on capabilities		R	PG	-
B-747	Plate, bottles, and general laboratory identification	Permanent acrylic adhesive ideal for flat surfaces	F		PG	-
B-8423	Vials, bottles, and general laboratory applications	THT with a permanent acrylic adhesive. Semi-gloss finish; excellent for bar code labels; label needs to slightly overlap itself	F A		G	R4300
<b>POLYPROPYLENE</b>						
B-449	Slides, plates, bottles, and general laboratory identification	Removable from flat surfaces; write-on capabilities	F A	R	PG	R4310
B-8425	Vials, bottles, and general laboratory applications	General purpose labelling; label needs to slightly overlap itself.	F		PG	R6000
<b>VINYL</b>						
B-351	Applications requiring evidence of tampering	Tamper-resistant film with a permanent acrylic adhesive; fractures easily to prevent removal	F		PG	R6210
B-427	Vials, tubes, slides, straws, and bottles.	Permanent acrylic adhesive; self-laminating; write-on capabilities; suitable for liquid nitrogen application and can be used to ID a frozen vial if label material is wrapped around itself, as in self-lamination	FN	S	VSPG	R4310
B-439	Plate, bottles, and general laboratory ID	Available in Blue, Green, Orange, Red, White, and Yellow	F	R V	PG	R4310

## LAB PAL™ Laboratory Label Printer



Take away the guesswork! Always be certain with LAB PAL.

The LAB PAL™ Laboratory Label Printer is portable, easy-to-use, and makes identifying your samples quick and efficient.

- Portable/Handheld
- Recommended for < 25 labels at a time
- Labels withstand extreme lab temperatures and solvents
- Pre-programmed vial and slide sizes
- One-touch time/date stamp
- Serialisation feature for quicker aliquots
- Laboratory symbols
- Affordable—every tech needs one
- Banner mode for general labelling
- Operates on 6 AA batteries or optional AC power adapter



Pre-programmed vial ID sizes (0.6, 1.5 & 2 ml)



Date/Time stamp



Specific laboratory symbols

Part Number	Description
LABPAL	LAB PAL label printer (includes PAL-375-461 label cartridge)
IDPAL-AC	AC adapter
IDPAL-HC	Hard-sided carry case

### PAL-375-461

Ideal for 0.60 ml vial

### PAL-500-461

Ideal for 1.50 ml vial

### PAL-750-461 PAL-750-488

Ideal for 2.0ml to 50.0ml vials  
Ideal for slides (Xylene resistant)

## LAB PAL™ Label Cartridges

Application	Material	Catalog Numbers		
		3/8" wide (9.5 mm)	1/2" wide (12.7 mm)	3/4" wide (19.1 mm)
FNAHLVPG	Polyester B461 / White*	PAL-375-461	PAL-500-461	PAL-750-461
FNA	Nylon Cloth B499 / White	PAL-375-499	PAL-500-499	PAL-750-499
F A	Polyester B488 / White	PAL-375-488	PAL-500-488	PAL-750-488
F A	Polyester B423 / White	PAL-375-423	PAL-500-423	PAL-750-423
F A	Polyester B430 / Clear	PAL-375-430	PAL-500-430	PAL-750-430
F	Vinyl B439 / White**	PAL-375-439	PAL-500-439	PAL-750-439

B-499 cartridges are 19 ft. long, all other are 21 ft. long.  
\* B461 is acceptable for use in liquid nitrogen only when wrapped upon itself.  
\*\* B439 vinyl is available in blue, green, orange, red, and yellow.

- Application Key**
- F** Freezer (-80°C)
  - N** Liquid Nitrogen (-196°C)
  - A** Autoclave
  - H** Hot Water Baths (100°C)
  - L** Low-Profile (extremely thin)
  - V** Vial Identification
  - S** Slide Identification
  - P** Plate Identification
  - G** General Identification

# LABXPRT™ v2.0 Label Printer



With Brady's LABXPRT™ v2.0 Label Printer, you have a powerful yet affordable tool at your fingertips! Produce legible, professional looking labels for your lab samples, while drastically reducing the time it actually takes to label. LABXPRT™ printer is now compatible with BradySoft™ Labelling Software.

- ▶ Continuous and pre-cut label styles, including round tops, self-laminating labels, and two-label combinations
- ▶ Mirror image printing or through-dish viewing of specimen labels
- ▶ Recommended for printing 20 to 100 labels at a time
- ▶ Continuous and die cut label styles, including tops, self-laminating, and two-label combinations
- ▶ Drop, Lock & Go Smart Cartridge combines labels and ribbon for a quick and easy change
- ▶ Built-in lab applications, including vial templates, time and date stamp, and auto-serialization for aliquots
- ▶ Bar coding capabilities – 2D (when connected to PC) and linear
- ▶ 300 dpi print head for sharper resolution on small fonts and bar codes
- ▶ Memory to store labels
- ▶ 140 Greek and laboratory symbols
- ▶ AA battery or AC power operation

Part Number	Description
<b>LABXPRT Printer &amp; Accessories</b>	
LABXPRT	v2.0 Printer & Accessories
LABXPRT-KEY	LABXPRT v2.0 LAB LABELLING SYSTEM *
LABXPRT-KEY-IDL	LABXPRT v2.0 + IDENTILAB S/WARE-1USER
LABXPRT-KEY-INTL	LABXPRT v2.0 LAB LABELLING SYSTEM **
LABXPRT-HC-KEY	HARD CASE FOR LABXPRT V2.0 PRINTER
XPRT-AC (SPARE)	AC ADAPTER FOR LABXPRT v2.0
XPRT-CABLE-USB	(SPARE) USB PC COMMUNICATIONS CABLE
LABXPRT-SER-USB	SERIAL-TO-USB CABLE ADAPTER (v1 only)
<b>IdentiLab Laboratory Labelling Software</b>	
IDL	IDENTILAB LAB ID SOFTWARE-SINGLE USER
IDL-SITE	IDENTILAB LAB ID SOFTWARE-SITE (4+ USERS)

\* Ships with: printer, AC power supply, PC cable, XSL-86-461 supply cartridge, CD containing manuals, and driver.  
 \*\* Ships with: same as LABXPRT-KEY but with international AC power supply.

## LABXPRT™ System Labels

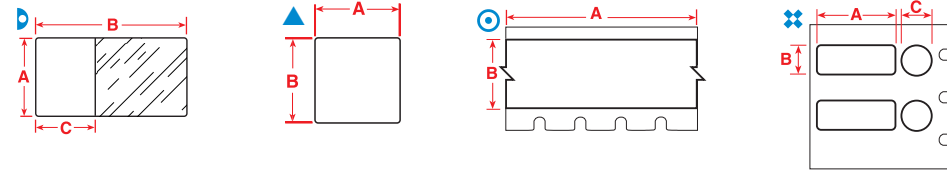

### ▶ CENTRIFUGE / EPPENDORF / PCR TUBE LABELS

Diagram	Part Number	Label Width A Inch (mm)	Label Height B Inch (mm)	Write-On Area/ Diameter C Inch (mm)	Labels/ Cartridge	Special Properties
<b>0.2ml PCR TUBE</b>						
D	XSL-108-461	0.187 (4.75)	1.500 (38.10)	0.700 (17.78)	500	F N A H S L V S
<b>0.5 TO 0.7ml TUBE</b>						
D	XSL-72-461	0.500 (12.70)	1.750 (44.45)	0.750 (19.05)	225	F N A H S L V S
D	XSL-123-461	0.375 (9.53)	1.125 (28.58)	0.750 (19.05)	500	F N A H S L V S
D	XSL-122-461	0.500 (12.70)	1.125 (28.58)	0.750 (19.05)	500	F N A H S L V S
⊙	XC-375-461	30 ft. (9.1m)	0.375 (9.53)		30 ft. roll	F N A H S L V S
▲	X-130-492	0.825 (20.96)	1.000 (25.40)		275	F N A H L V P G
▲	X-130-499	0.825 (20.96)	0.375 (9.53)		275	F N A V P G
**	X-118-499	1.000 (25.40)	0.375 (9.53)	0.375 (9.53)	300	F N A V P G
**	X-120-499	1.000 (25.40)	0.500 (12.70)	0.375 (9.53)	300	F N A V P G
<b>1.0 TO 8.0ml TUBE</b>						
D	XSL-74-461	0.500 (12.70)	2.200 (55.88)	0.750 (19.05)	175	F N A H S L V S
D	XSL-86-461	0.600 (15.24)	2.625 (66.68)	1.000 (25.40)	150	F N A H S L V S
D	XSL-124-461	0.500 (12.70)	1.650 (41.91)	0.750 (19.05)	225	F N A H S L V S
D	XSL-126-461	0.600 (15.24)	1.800 (45.72)	1.000 (25.40)	225	F N A H S L V S
⊙	XC-500-461	30 ft. (9.1m)	0.500 (12.70)		30 ft. roll	F N A H S L V S
▲	X-131-492	1.000 (25.40)	0.500 (12.70)		225	F N A H L V P G
▲	X-131-499	1.000 (25.40)	0.500 (12.70)		225	F N A V P G
**	X-118-499	1.000 (25.40)	0.375 (9.53)	0.375 (9.53)	300	F N A V P G
**	X-120-499	1.000 (25.40)	0.500 (12.70)	0.375 (9.53)	300	F N A V P G
**	X-117-499	1.000 (25.40)	0.500 (12.70)	0.440 (11.18)	300	F N A V P G

# LABXPRT™ Printer Labels

- F** Freezer environment
- N** Liquid nitrogen environment
- A** Autoclave environment
- H** Hot water (100°C) bath
- S** Self-laminating label
- L** Low-profile (extremely thin) label
- R** Removable/Repositionable
- V** Vial identification
- S** Slide identification
- P** Plate identification
- G** General identification

### ▶ CRYO VIAL LABELS

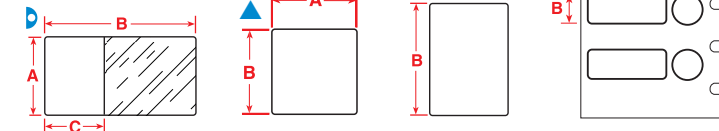

Diagram	Part Number	Label Width A Inch (mm)	Label Height B Inch (mm)	Write-On Area/ Diameter C Inch (mm)	Pieces/ Package	Special Properties
<b>0.6ml TUBE</b>						
D	XSL-72-461	0.500 (12.70)	1.750 (44.45)	0.750 (19.05)	225	F N A H S L V S
D	XSL-123-461	0.375 (9.53)	1.125 (28.58)	0.750 (19.05)	500	F N A H S L V S
D	XSL-122-461	0.500 (12.70)	1.125 (28.58)	0.750 (19.05)	500	F N A H S L V S
⊙	XC-500-461	30 ft. (9.1m)	0.500 (12.70)		30 ft. roll	F N A H S L V S
▲	X-130-492	0.825 (20.96)	1.000 (25.40)		275	F N A H L V P G
▲	X-130-499	0.825 (20.96)	0.375 (9.53)		275	F N A V P G
**	X-118-499	1.000 (25.40)	0.375 (9.53)	0.375 dia (9.53 dia)	300	F N A V P G
**	X-120-499	1.000 (25.40)	0.500 (12.70)	0.375 dia (9.53 dia)	300	F N A V P G
<b>1.0 TO 8.0ml TUBE</b>						
D	XSL-74-461	0.500 (12.70)	2.200 (55.88)	0.750 (19.05)	175	F N A H S L V
D	XSL-86-461	0.600 (15.24)	2.625 (66.68)	1.000 (25.40)	150	F N A H S L V S
D	XSL-72-461	0.500 (12.70)	1.750 (44.45)	0.750 (19.05)	225	F N A H S L V S
D	XSL-126-461	0.600 (15.24)	1.800 (45.72)	1.000 (25.40)	225	F N A H S L V S
D	XSL-125-461	1.000 (25.40)	1.750 (44.45)	1.000 (25.40)	225	F N A H S L V S
⊙	XC-500-461	30 ft. (9.1m)	0.500 (12.70)		30 ft. roll	F N A H S L V S
⊙	XC-1000-461	30 ft. (9.1m)	1.000 (25.40)		30 ft. roll	F N A H S L V S
★	X-156-492	0.900 (22.86)	1.000 (25.40)		225	F N A H L V P G
▲	X-131-499	1.000 (25.40)	0.500 (12.70)		225	F N A V P G
**	X-118-499	1.000 (25.40)	0.375 (9.53)	0.375 dia (9.53 dia)	300	F N A V P G
**	X-120-499	1.000 (25.40)	0.500 (12.70)	0.375 dia (9.53 dia)	300	F N A V P G
**	X-117-499	1.000 (25.40)	0.500 (12.70)	0.440 dia (11.18 dia)	300	F N A V P G

### ▶ VIAL TOP LABELS

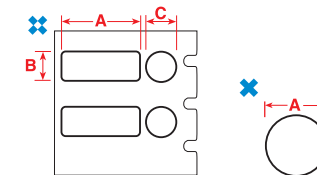
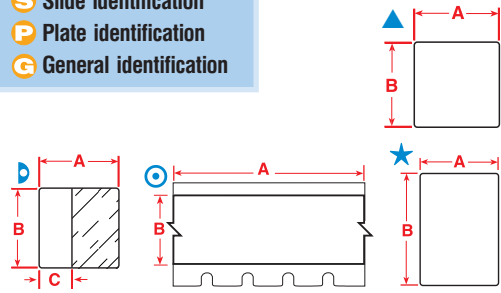

Diagram	Part Number	Label Width A Inch (mm)	Label Height B Inch (mm)	Write-On Area/ Diameter C Inch (mm)	Pieces/ Package	Special Properties
<b>0.6 - 1.5ml VIAL / TUBE</b>						
*	X-82-499	0.375 (9.53)			300	F N A V P G
*	X-82-499-YL-BK	0.375 (9.53)			300	F N A V P G
*	X-82-499-OR-BK	0.375 (9.53)			300	F N A V P G
*	X-82-499-RD-BK	0.375 (9.53)			300	F N A V P G
**	X-118-499	1.000 (25.40)	0.375 (9.53)	0.375 dia (9.53 dia)	300	F N A V P G
**	X-120-499	1.000 (25.40)	0.500 (12.70)	0.375 dia (9.53 dia)	300	F N A V P G
<b>1.0 - 2.0ml VIAL / TUBE</b>						
*	X-83-499	0.500 (12.70)			300	F N A V P G
*	X-83-499-YL-BK	0.500 (12.70)			300	F N A V P G
*	X-83-499-OR-BK	0.500 (12.70)			300	F N A V P G
*	X-83-499-RD-BK	0.500 (12.70)			300	F N A V P G
**	X-118-499	1.000 (25.40)	0.375 (9.53)	0.375 dia (9.53 dia)	300	F N A V P G
**	X-120-499	1.000 (25.40)	0.500 (12.70)	0.375 dia (9.53 dia)	300	F N A V P G
**	X-117-499	1.000 (25.40)	0.500 (12.70)	0.440 dia (11.18 dia)	300	F N A V P G

# LABXPERT™ Printer Labels

- F** Freezer environment
- N** Liquid nitrogen environment
- A** Autoclave environment
- H** Hot water (100°C) bath
- S** Self-laminating label
- L** Low-profile (extremely thin) label
- R** Removable/Repositionable

- V** Vial identification
- S** Slide identification
- P** Plate identification
- G** General identification



## CONICAL AND LARGE TUBE LABELS

Diagram	Part Number	Label Width A Inch (mm)	Label Height B Inch (mm)	Write-On Area/ Diameter C Inch (mm)	Labels/ Cartridge	Special Properties
<b>14.0 - 15.0ml CONICALS</b>						
▷	XSL-119-461	1.500 (38.10)	3.750 (95.25)	1.250 (31.75)	100	F N A H S L V S
▷	XSL-129-461	1.500 (38.10)	2.250 (57.15)	1.250 (31.75)	175	F N A H S L V S
○	XC-1000-461	30 FT	1.000 (25.40)		30 ft roll	F N A H S L V S
○	XC-1250-461	30 ft.	1.250 (31.75)		30 ft roll	F N A H S L V S
▲	X-78-492	1.900 (48.26)	1.000 (25.40)		125	F N A H L V P G
★	X-132-499	1.250 (31.75)	1.500 (38.10)		200	F N A L V P G
<b>50.0ml CONICALS</b>						
▷	XSL-119-461	1.500 (38.10)	3.750 (95.25)	1.250 (31.75)	100	F N A H S L V S
○	XC-1000-461	30 FT	1.000 (25.40)		30 ft roll	F N A H S L V S
○	XC-1250-461	30 ft.	1.250 (31.75)		30 ft roll	F N A H S L V S
▲	X-78-492	1.900 (48.26)	1.000 (25.40)		125	F N A H L V P G
★	X-78-499	1.000 (25.40)	1.900 (48.26)		125	F N A L V P G

## WELL PLATE LABEL

Diagram	Part Number	Label Width A Inch (mm)	Label Height B Inch (mm)	Labels/ Cartridge	Special Properties
▲	X-81-488	1.900 (48.26)	0.250 (6.35)	200	F A S P G

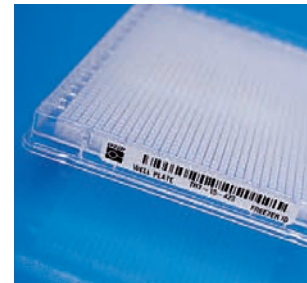
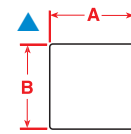

## SLIDE LABELS

Diagram	Part Number	Label Width A Inch (mm)	Label Height B Inch (mm)	Labels/ Cartridge	Special Properties
▲	X-97-488	0.900 (22.86)	0.900 (22.86)	350	F A S P G
▲	X-81-488	1.900 (48.26)	0.250 (6.35)	200	F A S P G

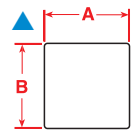

# LABXPERT™ Printer Labels

- F** Freezer environment
- N** Liquid nitrogen environment
- A** Autoclave environment
- H** Hot water (100°C) bath
- S** Self-laminating label
- L** Low-profile (extremely thin) label
- R** Removable/Repositionable

- V** Vial identification
- S** Slide identification
- P** Plate identification
- G** General identification

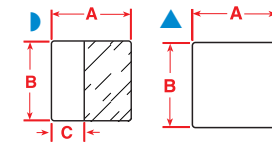

## STRAW LABELS

Diagram	Part Number	Straw Description	Label Width A Inch (mm)	Label Height B Inch (mm)	Write-On Area/ Diameter C Inch (mm)	Pieces/ Package	Special Properties
▷	XSL-133-427	Small Straws	1.750 (44.45)	1.000 (25.40)	0.375 (9.530)	175	F N S V S P G
▷	XSL-134-427	Large Straws	1.750 (44.45)	1.500 (38.10)	0.500 (12.70)	175	F N S V S P G
▲	X-105-427-AW	Straw Rods	1.100 (27.94)	0.250 (6.350)		500	F N S V S P G

## BOTTLES, FLASKS, DISHES, AND GENERAL LAB ID

Diagram	Part Number	Material	Label Width A Inch (mm)	Label Height B Inch (mm)	Pieces/ Package	Special Properties
▲	X-131-498	Removable/Repositionable Adhesive	1.000 (25.40)	0.500 (12.70)	225	F R V P G
▲	X-78-498	Removable/Repositionable Adhesive	1.000 (25.40)	1.900 (48.26)	125	F R V P G
★	X-162-498	Permanent Adhesive	0.500 (12.70)	1.500 (38.10)	165	F N A L V P G
▲	X-130-499	Permanent Adhesive	0.825 (20.96)	0.375 (9.530)	275	F N A L V P G
★	X-132-499	Permanent Adhesive	1.250 (31.75)	1.500 (38.10)	200	F N A L V P G
▲	X-131-499	Permanent Adhesive	1.000 (25.40)	0.500 (12.70)	225	F N A L V P G
▲	X-78-499	Permanent Adhesive	1.000 (25.40)	1.900 (48.26)	125	F N A L V P G
▲	X-162-499	Permanent Adhesive	1.500 (38.10)	0.500 (12.70)	165	F N A L V P G
▲	X-30-499	Permanent Adhesive	1.500 (38.10)	0.750 (19.05)	300	F N A L V P G

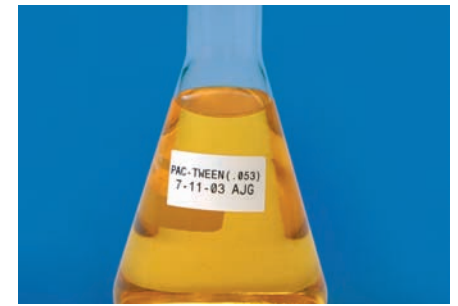
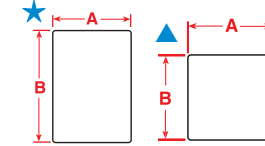

## TAMPER RESISTANT / INDICATING POLYESTER

Diagram	Part Number	Label Width A Inch (mm)	Label Height B Inch (mm)	Pieces/ Package	Special Properties
▲	X-20-351	2.000 (50.80)	1.000 (25.40)	200	F P G
▲	X-17-351	1.000 (25.40)	0.500 (12.70)	500	F P G

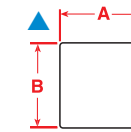

## TLS 2200® Thermal Labelling System Version 4.0



The TLS 2200® Thermal Labelling System Version 4.0 is a lightweight (2.75 lb./1.25 kg) hand-held printer that provides thermal transfer printing, bar coding, and multiple material configurations, including die cut and continuous labels. Printing labels for vials, test tubes, well plates, beakers, and slides is fast and easy.

- ▶ Recommended for printing 25 to 250 labels at a time
- ▶ Handheld, portable design
- ▶ PC compatible (using IdentiLab™, LabelMark™ software or BradySoft™ 8)
- ▶ 203 dpi print resolution
- ▶ Easy to serialize or print multiple labels, for quicker aliquots
- ▶ Prints code 3 of 9 bar codes (also prints 128 and UPC bar codes when connected to a PC)

Part Number	Description
TLS2200	Printer (system includes TLS 2200 printer, hard case, R6210 ribbon, rechargeable battery pack, battery charger, Quick Start Guide, manual, PC cable, and test labels [PTL-19-423].

## TLS PC Link™ Thermal Labelling System



The TLS PC Link Thermal Labelling System utilizes all of the available TLS 2200® materials and ribbons. Its small size and PC-only operation makes it ideal for the lab bench.

- ▶ PC connection only
- ▶ Packaged with IdentiLab™ label software
- ▶ 203 dpi print resolution
- ▶ Ideal for printing less than 250 labels at a time

Part Number	Description
TLSPC	Printer (system includes TLS PC Link printer, rechargeable battery pack, power supply/battery charger, R6210 ribbon, sample labels (PTL-19-423), Quick Start Guide, manuals, communications cable, and Windows™ drivers)

## TLS 2200® v4.0/ TLS PC Link™ Printer Labels

- F** Freezer environment
- N** Liquid nitrogen environment
- A** Autoclave environment
- H** Hot water (100°C) bath
- S** Self-laminating label
- L** Low-profile (extremely thin) label
- R** Removable/Repositionable
- V** Vial identification
- S** Slide identification
- P** Plate identification
- G** General identification

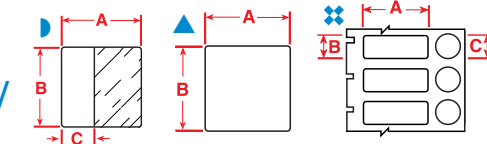

### ▶ CENTRIFUGE / EPPENDORF / PCR TUBE LABELS

Diagram	Part Number	Label Width A Inch (mm)	Label Height B Inch (mm)	Write-On Area/ Diameter C Inch (mm)	Pieces/ Package	Printer Ribbon	Special Properties
<b>0.2ml PCR TUBE</b>							
▶	PTL-108-461	1.500 (38.10)	0.187 (4.75)	0.700 (17.78)	750	R4310	<b>FNAHSL V</b>
<b>0.5 TO 0.7ml TUBE</b>							
▲	PTL-11-498	0.750 (19.05)	0.500 (12.70)		500	R6210	<b>F RV PG</b>
▲	BPTL-11-498	0.750 (19.05)	0.500 (12.70)		5,000	R6210	<b>F RV PG</b>
▲	PTL-11-499	0.750 (19.05)	0.500 (12.70)		500	R4310	<b>FNA RV PG</b>
▲	PTL-84-499	0.900 (22.86)	0.500 (12.70)		500	R4310	<b>FNA RV PG</b>
▲	PTL-16-498	0.375 (9.53)	1.000 (25.40)		500	R6210	<b>F RV PG</b>
▲	PTL-16-499	0.375 (9.53)	1.000 (25.40)		500	R4310	<b>FNA RV PG</b>
⌘	PTL-98-499	1.000 (25.40)	0.375 (9.53)	0.375 (9.53) dia.	500	R4310	<b>FNA RV PG</b>
▲	PTL-112-490	1.250 (25.40)	0.375 (9.53)		500	R4310	<b>FNAH L RV PG</b>
▶	PTL-73-461	1.800 (45.72)	0.375 (9.53)	0.750 (19.05)	500	R4310	<b>FNAHSL V</b>
▶	PTL-72-461	1.800 (45.72)	0.500 (12.70)	0.750 (19.05)	500	R4310	<b>FNAHSL V</b>
▶	PTL-74-427	2.200 (55.88)	0.500 (12.70)	0.750 (19.05)	100	R4310	<b>FN S V</b>
▶	PTL-74-461	2.200 (55.88)	0.500 (12.70)	0.750 (19.05)	100	R4310	<b>FNAHSL VS</b>
<b>1.5 TO 2.0ml TUBE</b>							
▲	PTL-84-499	0.900 (22.86)	0.500 (12.70)		500	R4310	<b>FNA RV PG</b>
▶	PTL-76-461	1.625 (41.28)	0.600 (15.24)	1.000 (25.40)	250	R4310	<b>FNAHSL V</b>
▲	PTL-76-490	1.625 (41.28)	0.600 (15.24)		250	R4310	<b>FNAH L RV PG</b>
▶	PTL-74-427	2.200 (55.88)	0.500 (12.70)	0.750 (19.05)	100	R4310	<b>FN S V</b>
▶	PTL-74-461	2.200 (55.88)	0.500 (12.70)	0.750 (19.05)	100	R4310	<b>FNAHSL V</b>
▶	PTL-86-461	0.600 (15.24)	2.625 (66.68)	1.000 (25.40)	100	R4310	<b>FNAHSL V</b>

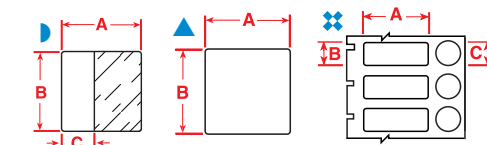

### ▶ CRYO VIAL LABELS

Diagram	Part Number	Label Width A Inch (mm)	Label Height B Inch (mm)	Write-On Area/ Diameter C Inch (mm)	Pieces/ Package	Printer Ribbon	Special Properties
<b>0.6ml VIAL / TUBE</b>							
▲	PTL-11-498	0.750 (19.05)	0.500 (12.70)		500	R6210	<b>F RV PG</b>
▲	BPTL-11-498	0.500 (12.70)	0.750 (19.05)		5,000	R6210	<b>F RV PG</b>
▲	PTL-11-499	0.750 (19.05)	0.500 (12.70)		500	R4310	<b>FNA RV PG</b>
▲	PTL-84-499	0.900 (22.86)	0.500 (12.70)		500	R4310	<b>FNA RV PG</b>
▶	PTL-74-427	2.200 (55.88)	0.500 (12.70)	0.750 (19.05)	100	R4310	<b>FN S V</b>
▶	PTL-74-461	2.200 (55.88)	0.500 (12.70)	0.750 (19.05)	100	R4310	<b>FNAHSL V</b>
<b>1.0 - 8.0ml VIAL / TUBE</b>							
▲	PTL-84-499	0.900 (22.86)	0.500 (12.70)		500	R4310	<b>FNA RV PG</b>
⌘	PTL-98-499	1.000 (25.40)	0.375 (9.53)	0.375 (9.53) dia.	500	R4310	<b>FNA RV PG</b>
▶	PTL-76-461	1.625 (41.28)	0.600 (15.24)	1.000 (25.40)	250	R4310	<b>FNAHSL V</b>
▲	PTL-76-490	1.625 (41.28)	0.600 (15.24)		250	R4310	<b>FNAH L RV PG</b>
▲	PTL-78-490	1.900 (48.26)	1.000 (15.24)		250	R4310	<b>FNAH L RV PG</b>
▶	PTL-86-461	0.600 (15.24)	2.625 (66.68)	1.000 (25.40)	100	R4310	<b>FNAHSL V</b>
▶	PTL-75-427	2.625 (66.68)	1.000 (25.40)	1.000 (25.40)	100	R4310	<b>FN S V</b>
▶	BPTL-75-461	2.625 (66.68)	1.000 (25.40)	1.000 (25.40)	1,000	R4310	<b>FNAHSL V</b>
▶	PTL-75-461	2.625 (66.68)	1.000 (25.40)	1.000 (25.40)	100	R4310	<b>FNAHSL V</b>
▶	PTL-75-461-YL	2.625 (66.68)	1.000 (25.40)	1.000 (25.40)	100	R4310	<b>FNAHSL V</b>
<b>12.0 - 24.0ml VIAL / TUBE</b>							
▲	PTL-29-498	1.500 (38.10)	0.500 (12.70)		500	R6210	<b>F RV PG</b>
▲	PTL-29-499	0.500 (12.70)	1.500 (38.10)		500	R4310	<b>FNA RV PG</b>
▶	PTL-77-461	3.500 (88.90)	1.500 (38.10)	1.250 (31.75)	250	R4310	<b>FNAHSL V</b>

### ▶ PRINT RIBBONS

#### TLS 2200 / TLS PC Link Print Ribbons

Part Number	Description	Length
R4310	R4310 BLACK ribbon	75 ft (22.9 m)
R6010	R6010 BLACK ribbon	75 ft (22.9 m)
R6210	R6210 BLACK ribbon	75 ft (22.9 m)
R4410-BL	R4410 BLUE ribbon	75 ft (22.9 m)
R4410-RD	R4410 RED ribbon	75 ft (22.9 m)
R4410-WT	R4410 WHITE ribbon	75 ft (22.9 m)

#### TLS 2200/ TLS PC Link Print Ribbon Selection Guide

Match your material with the appropriate ribbon.

B#s	Material	R4310	R4410 (colors)	R6010	*R6210
351	Vinyl	—	—	—	●
423	Polyester	—	△	●	△
424	Paper	●	—	—	—
427	Vinyl	●	—	—	△
430	Polyester	—	△	●	△
439	Vinyl	—	△	●	△
449	Polypropylene	●	—	—	—
461	Polyester	●	—	—	△
488	Polyester	●	—	—	△
490	Polyester	●	—	—	△
498	Vinyl Cloth	△	—	—	●
499	Nylon Cloth	●	—	—	△

● Recommended ribbon for use with respective material.

△ Acceptable ribbon for use with respective material.

\* R6210 ribbon included with printers.

# TLS 2200® v4.0/ TLS PC Link™ Printer Labels

- F** Freezer environment
- N** Liquid nitrogen environment
- A** Autoclave environment
- H** Hot water (100°C) bath
- S** Self-laminating label
- L** Low-profile (extremely thin) label
- R** Removable

- V** Vial identification
- S** Slide identification
- P** Plate identification
- G** General identification

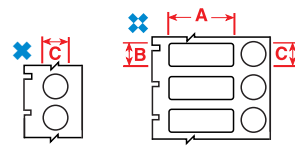

## VIAL TOP LABELS

Diagram	Part Number	Label Width A Inch (mm)	Label Height B Inch (mm)	Write-On Area/ Diameter C Inch (mm)	Pieces/ Package	Printer Ribbon	Special Properties
<b>0.6 - 1.5ml VIAL / TUBE</b>							
✱	PTL-82-499	-	-	0.375 (9.53)	500	R4310	FNA V PG
✱	PTL-82-499-YL	-	-	0.375 (9.53)	500	R4310	FNA V PG
✱	PTL-98-499	1.000 (25.40)	0.375 (9.53)	0.375 (9.53)	500	R4310	FNA V PG
<b>1.0 - 2.0ml VIAL / TUBE</b>							
✱	PTL-83-499	-	-	0.500 (12.70)	500	R4310	FNA V PG
✱	PTL-83-499-YL	-	-	0.500 (12.70)	500	R4310	FNA V PG

## CONICAL / BOTTLE / PETRI DISH / DEEP WELL PLATE LABELS

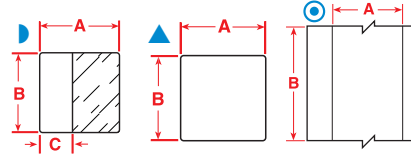
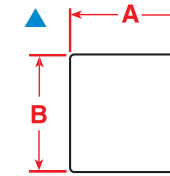

Diagram	Part Number	Label Width A Inch (mm)	Label Height B Inch (mm)	Write-On Area/ Diameter C Inch (mm)	Pieces/ Package	Printer Ribbon	Special Properties
<b>14.0 / 15.0ml CONICAL TUBE</b>							
▲	PTL-113-490	2.200 (55.88)	1.500 (38.10)		100	R4310	FNAH L V PG
▶	PTL-77-461	3.500 (88.90)	1.500 (38.10)	1.250 (31.75)	250	R4310	FNAHSL V
<b>50.0ml CONICAL TUBE / BOTTLES / PETRI DISH / DEEP WELL PLATE</b>							
▲	PTL-7-423	0.500 (12.70)	0.500 (12.70)		500	R6010	A PG
▲	PTL-14-423	1.000 (25.40)	0.187 (4.75)		750	R6010	A PG
▲	PTL-15-423	1.000 (25.40)	0.255 (6.99)		750	R6010	A PG
▲	PTL-17-423	1.000 (25.40)	0.500 (12.70)		500	R6010	A PG
▲	PTL-17-430	1.000 (25.40)	0.500 (12.70)		500	R6010	A PG
▲	PTL-17-449	1.000 (25.40)	0.500 (12.70)		500	R4310	F A R V PG
▲	PTL-17-498	1.000 (25.40)	0.500 (12.70)		500	R6210	F R V PG
◎	PTL-42-439-OR	1.000 (25.40)	50.00 ft (15 m)		1 roll	R4310	F V PG
◎	PTL-42-439-YL	1.000 (25.40)	50.00 ft (15 m)		1 roll	R4310	F V PG
▲	PTL-29-498	1.500 (38.10)	0.500 (12.70)		500	R6210	F R V PG
▲	PTL-29-499	0.500 (12.70)	1.500 (38.10)		500	R4310	FNA R V PG
▲	PTL-30-427-AW*	1.500 (38.10)	0.750 (19.05)		250	R4310	FNA V PG
▲	PTL-30-499	0.750 (19.05)	1.500 (38.10)		250	R4310	FNA V PG
▲	PTL-31-423	1.500 (38.10)	1.000 (25.40)		250	R6210	FNA PG
▲	PTL-31-498	1.000 (25.40)	1.500 (38.10)		250	R6210	F R V PG
▲	PTL-31-499	1.000 (25.40)	1.500 (38.10)		250	R4310	FNA V PG
▲	PTL-114-490	3.750 (95.25)	1.500 (38.10)		100	R4310	FNAH L V PG
▲	PTL-78-427-AW*	1.900 (48.26)	1.000 (25.40)		250	R4310	FNA V PG
▲	PTL-78-488	1.900 (48.26)	1.000 (25.40)		250	R4310	FNA V PG
▲	PTL-78-499	1.900 (48.26)	1.000 (25.40)		250	R4310	FNA V PG
▲	PTL-20-423	2.000 (50.80)	1.000 (25.40)		100	R6010	A PG
▲	PTL-22-423	3.000 (76.20)	1.000 (25.40)		100	R6010	A PG
◎	PTL-8-430	0.500 (12.70)	50.00 ft (15 m)		1 roll	R6010	A PG

# TLS 2200® v4.0/ TLS PC Link™ Printer Labels

- F** Freezer environment
- N** Liquid nitrogen environment
- A** Autoclave environment
- H** Hot water (100°C) bath
- S** Self-laminating label
- L** Low-profile (extremely thin) label
- R** Removable/Repositionable

- V** Vial identification
- S** Slide identification
- P** Plate identification
- G** General identification



## SLIDE LABELS

Diagram	Part Number	Label Width A Inch (mm)	Label Height B Inch (mm)	Pieces/ Package	Printer Ribbon	Special Properties
▲	PTL-80-424	0.750 (19.05)	0.900 (22.86)	250	R4310	F S G
▲	PTL-80-488	0.750 (19.05)	0.900 (22.86)	250	R4310	F A S PG
▲	PTL-97-488	0.900 (22.86)	0.900 (22.86)	250	R4310	F A S PG

## STRAW LABELS

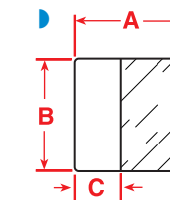

Diagram	Part Number	Label Width A Inch (mm)	Label Height B Inch (mm)	Write-On Area/ Diameter C Inch (mm)	Pieces/ Package	Printer Ribbon	Special Properties
<b>0.25ml STRAW</b>							
▶	PTL-19-427	1.000 (25.40)	1.000 (25.40)	0.375 (9.53)	250	R4310	F N S V
<b>0.5ml STRAW</b>							
▶	PTL-21-427	1.000 (25.40)	2.500 (63.50)	0.750 (19.05)	100	R4310	F N S V
<b>STRAW ROD</b>							
▶	PTL-105-427-AW*	1.100 (27.94)	0.250 (6.35)	0.250 (6.35)	750	R4310	F N V PG

\* Label is all white (no clear tail)

## WELL PLATE LABELS

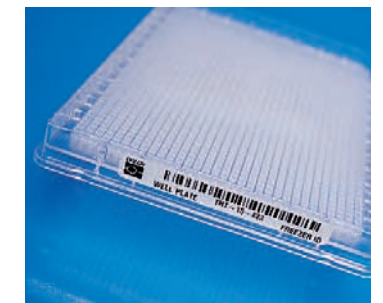
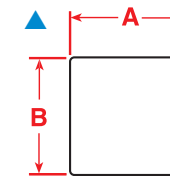

Diagram	Part Number	Label Width A Inch (mm)	Label Height B Inch (mm)	Pieces/ Package	Printer Ribbon	Special Properties
▲	PTL-81-488	1.900 (48.26)	0.250 (6.35)	750	R4310	F A S PG
▲	PTL-81-499	1.900 (48.26)	0.250 (6.35)	750	R4310	FNA V PG
▲	PTL-2-423	2.000 (50.80)	0.250 (6.35)	100	R6010	F A PG

# Brady Benchtop Thermal Transfer (THT) Printers – Outperforming Expectations

Performance printers for your lab applications, from compact, economical lab benchtop printers to higher resolution label printers. Ideal for general purpose identification, slides, well plates, and vial identification. Print widths up to 4.1". Use with BradySoft™ 8 Labelling Software or IdentiLab™ Label Software (sold separately on p. 15).



► **BRADY IP™ PRINTER SYSTEM**  
Simplify your printing with the Brady IP™ Thermal Transfer Printer- just load, click, and print, it's that simple. Brady's IP™ Printer is a new, smart solution for high-performance printing.

- Uses Smart Cell technology for communication between printer, materials, ribbon and software.
- Reduced set-up time, material recognition, and automatic software formatting for ease-of-use.

Part Number	Description
<b>IP Series Printer Models</b>	
BP-IP300	Brady IP Printer - 300dpi Standard
BP-IP600	Brady IP Printer - 600dpi Standard

## Performance for Higher Volume and More Demanding Applications



TAGUS™ Printer  
The value of versatility.

► **BRADYPRINTER™ BENCHTOP THT PRINTER MODELS**  
BRADYPRINTER™ TAGUS™ Thermal Transfer Printer and BP-PR Plus printers excels at higher-volume print jobs.

- High resolution printing (up to 600 dots per inch depending on model)
- Fastest print speeds

Part Number	Description
<b>TAGUS T200 MODEL</b>	
BP-T200	Brady Tagus T200 Printer – Standard
BP-T200	Brady Tagus T200 with Internal Cutter
<b>TAGUS T300 MODEL</b>	
BP-T300	Brady Tagus T300 Printer – Standard
BP-T300-C	Brady Tagus T300 with Internal Cutter
<b>PR PLUS MODEL</b>	
BP-THT-PR200PLUS	Brady THT BP-PR200 Plus Printer
BP-THT-PR300PLUS	Brady THT BP-PR300 Plus Printer
BP-THT-PR600PLUS	Brady THT BP-PR600 Plus Printer

PR Plus Printer  
The choice for tough jobs.



### Ribbon Selection Guide for Benchtop THT Printers

B#	Material	Series 4300	Series 4400 (colors)	Series 4900	Series 6000	Series 6200
B-351	Vinyl	△	—	—	—	●
B-423	Polyester	—	△	△	●	△
B-424	Paper	●	—	—	—	—
B-427	Vinyl	●	—	—	—	△
B-430	Polyester	●	—	—	●	△
B-449	Polypropylene	—	—	—	—	●

Match your material with the appropriate ribbon.

B#	Material	Series 4300	Series 4400 (colors)	Series 4900	Series 6000	Series 6200	Series 6400
B-461	Polyester	●	—	—	—	△	—
B-488	Polyester	●	—	—	—	—	—
B-490	Polyester	●	—	—	—	—	—
B-492	Polyester	—	—	—	—	—	●
B-498	Vinyl Cloth	△	—	—	●	●	—
B-499	Nylon Cloth	△	—	●	△	△	—

● Recommended ribbon for use with respective material.  
△ Acceptable ribbon for use with respective material.

## Brady Benchtop THT Printer Labels

- F Freezer environment
- N Liquid nitrogen environment
- A Autoclave environment
- H Hot water (100°C) bath
- S Self-laminating label
- L Low-profile (extremely thin) label
- R Removable/Repositionable

- V Vial identification
- S Slide identification
- P Plate identification
- G General identification

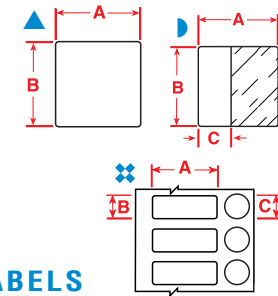

### ► CENTRIFUGE / EPPENDORF / PCR TUBE LABELS

Diagram	Part Number	Label Width A Inch (mm)	Label Height B Inch (mm)	Write-On Area/ Diameter C Inch (mm)	Labels/ Roll	BP1344 Model Ribbon	200/300MVP, 600X, 6441 Ribbon	Special Properties
<b>0.5 TO 0.7ml TUBE</b>								
▲	THT-68-499-10	0.500 (12.70)	0.750 (19.05)		10,000	R4901	R4902	FNA V PG
▲	THT-152-499-3	0.375 (9.53)	1.000 (25.40)		3,000	R4301	R4306	FNA V PG
▲	THT-152-492-3	1.000 (25.40)	0.375 (9.53)		3,000	R43101	R6400	FNAH L V PG
⚡	THT-163-492-3	1.000 (25.40)	0.375 (9.53)	0.375 (9.53)	3,000	R4301	R6400	FNAH L V PG
▶	THT-123-461-3	1.800 (45.72)	0.375 (9.53)	0.750 (19.05)	3,000	R4301	R4302	FNAHSL V
▶	THT-122-461-3	1.800 (45.72)	0.500 (12.70)	0.750 (19.05)	3,000	R4301	R4302	FNAHSL V
▶	THT-127-461-3	2.200 (55.88)	0.500 (12.70)	0.750 (19.05)	3,000	R4301	R4302	FNAHSL V
<b>1.5 TO 2.0ml TUBE</b>								
▲	THT-126-499-3	0.500 (12.70)	0.500 (12.70)		3,000	R4301	R4302	FNA V PG
▶	THT-133-461-3	1.625 (41.28)	0.600 (15.24)	1.000 (25.40)	3,000	R4301	R4302	FNAHSL V
▲	THT-59-492	1.000 (25.40)	0.500 (12.70)		10,000	R4301	R6400	FNAH L V PG
⚡	THT-181-492-3	1.000 (25.40)	0.500 (12.70)	0.375 (9.53)	3,000	R4301	R6400	FNAH L V PG
⚡	THT-182-492-3	1.000 (25.40)	0.500 (12.70)	0.440 (11.18)	3,000	R4301	R6400	FNAH L V PG
▶	THT-127-461-3	2.200 (55.88)	0.500 (12.70)	0.750 (19.05)	3,000	R4301	R4302	FNAHSL V
▶	THT-153-461-3	2.625 (66.68)	0.600 (15.24)	1.000 (25.40)	3,000	R4301	R4300	FNAHSL V

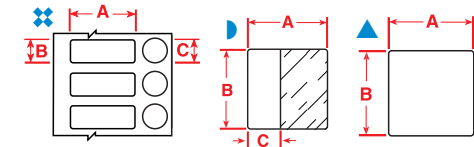

### ► VIAL / TUBE LABELS

Diagram	Part Number	Label Width A Inch (mm)	Label Height B Inch (mm)	Write-On Area/ Diameter C Inch (mm)	Labels/ Roll	BP1344 Model Ribbon	200/300MVP, 600X, 6441 Ribbon	Special Properties
<b>0.6ml VIAL / TUBE</b>								
▲	THT-68-499-10	0.750 (19.05)	0.500 (12.70)		1,000	R4901	R4902	FNA V PG
▲	THT-125-499-3	0.900 (22.86)	0.500 (12.70)		3,000	R4301	R4306	FNA V PG
▲	THT-59-492	1.000 (25.40)	0.500 (12.70)		10,000	R4301	R6400	FNAH L V PG
▶	THT-127-461-3	2.200 (55.88)	0.500 (12.70)	0.750 (19.05)	3,000	R4301	R4302	FNAHSL V
<b>1.0 - 8.0ml VIAL / TUBE</b>								
▲	THT-125-499-3	0.900 (22.86)	0.500 (12.70)		3,000	R4301	R4306	FNA V PG
⚡	THT-126-499-3	0.900 (22.86)	0.500 (12.70)	0.500 (12.70)	3,000	R4301	R4306	FNA V PG
▶	THT-133-461-3	1.625 (41.28)	0.600 (15.24)	1.000 (25.40)	3,000	R4301	R4302	FNAHSL V
▲	THT-59-492	1.000 (25.40)	0.500 (12.70)		10,000	R4301	R6400	FNAH L V PG
▲	THT-179-492	1.000 (25.40)	1.000 (25.40)		3,000	R4301	R6400	FNAH L V PG
▶	THT-153-461-3	2.625 (66.68)	0.600 (15.24)	1.000 (25.40)	3,000	R4301	R4300	FNAHSL V
▶	THT-131-461-3	2.625 (66.68)	1.000 (25.40)	1.000 (25.40)	3,000	R4301	R4300	FNAHSL V
<b>12.0 - 24.0ml VIAL / TUBE</b>								
▶	THT-134-461-3	3.500 (88.90)	1.500 (38.10)	1.250 (31.75)	3,000	R4301	R4307	FNAHSL V
▶	THT-139-461-2	5.250 (133.35)	1.000 (25.40)	1.000 (25.40)	2,000	R4301	R4306	FNAHSL V

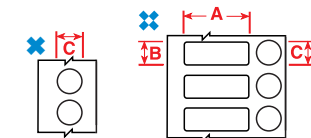

### ► VIAL TOP LABELS

Diagram	Part Number	Label Width A Inch (mm)	Label Height B Inch (mm)	Write-On Area/ Diameter C Inch (mm)	Labels/ Roll	BP1344 Model Ribbon	200/300MVP, 600X, 6441 Ribbon	Special Properties
<b>0.6 - 1.5ml VIAL / TUBE</b>								
*	THT-143-499-3	-	-	0.375 (9.53)	3,000	R4301	R4302	FNA V PG
*	THT-144-492-3	-	-	0.500 (12.70)	3,000	R4301	R6400	FNAH L V PG
<b>1.0 - 2.0ml VIAL / TUBE</b>								
*	THT-143-492-3	-	-	0.375 (9.53)	3,000	R4301	R6400	FNAH L V PG
*	THT-144-499-3	-	-	0.500 (12.70)	3,000	R4301	R4302	FNA V PG
⚡	THT-126-499-3	0.900 (22.86)	0.500 (12.70)	0.500 (12.70)	3,000	R4301	R4302	FNA V PG
⚡	THT-163-499-3	1.000 (25.40)	0.375 (9.53)	0.375 (9.53)	3,000	R4301	R4300	FNA V PG

## Brady Benchtop THT Printer Labels

- F** Freezer environment
- N** Liquid nitrogen environment
- A** Autoclave environment
- H** Hot water (100°C) bath
- S** Self-laminating label
- L** Low-profile (extremely thin) label
- R** Removable/Repositionable
- V** Vial identification
- S** Slide identification
- P** Plate identification
- G** General identification

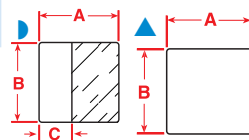

### CONICAL / BOTTLE / PETRI DISH / DEEP WELL PLATE LABELS

Diagram	Part Number	Label Width A Inch (mm)	Label Height B Inch (mm)	Write-On Area/ Diameter C Inch (mm)	Labels/ Roll	BP1344 Model Ribbon	200/300MVP, 600X, 6441 Ribbon	Special Properties
<b>14.0 - 15.0ml CONICAL TUBE</b>								
▲	THT-156-492-3	1.900 (48.30)	1.000 (25.40)		3,000	R4301	R6400	F N A H L V P G
▶	THT-134-461-3	3.500 (88.90)	1.500 (38.10)	1.250 (31.75)	3,000	R4301	R4307	F N A H S L V
<b>50.0ml CONICAL TUBE / BOTTLES / PETRI DISH / DEEP WELL PLATE</b>								
▲	THT-17-423-3	2.000 (50.80)	1.000 (25.40)		3,000	R6001	R6000	F A P G
▲	THT-41-423-10	1.000 (25.40)	0.187 (4.75)		10,000	R6001	R6002	F A P G
▲	THT-51-423-10	1.000 (25.40)	0.250 (6.35)		1,000	R6001	R6002	F A P G
▲	THT-5-433-10	1.000 (25.40)	0.500 (12.70)		10,000	R6001	R6002	F A R P G
▲	THT-135-427-AW-3*	1.500 (38.10)	0.750 (19.05)		3,000	R4301	R4306	F N V P G
▲	THT-136-499-3	1.500 (38.10)	0.750 (19.05)		3,000	R4301	R4302	F N A V P G
▲	THT-137-427-AW-3*	2.000 (50.80)	1.000 (25.40)		3,000	R4301	R4302	F N V P G
▲	THT-137-499-3	2.000 (50.80)	1.000 (25.40)		3,000	R4301	R4302	F N A V P G
▲	THT-156-492-3	1.900 (48.30)	1.000 (25.40)		3,000	R4301	R6400	F N A H L V P G
▶	THT-139-461-2	5.250 (133.35)	1.000 (25.40)	1.500 (38.10)	2,000	R4301	R4306	F N A H L V P G
▶	THT-5-433-10	1.000 (25.40)	0.500 (12.70)		10,000	R6001	R6002	F A P G
▶	THT-19-433-1	3.000 (76.20)	2.000 (50.80)		1,000	R6001	R6002	F A P G

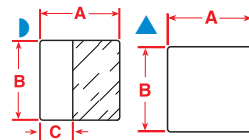

### SLIDE LABELS

Diagram	Part Number	Label Width A Inch (mm)	Label Height B Inch (mm)	Write-On Area/ Diameter C Inch (mm)	Labels/ Roll	BP1344 Model Ribbon	200/300MVP, 600X, 6441 Ribbon	Special Properties
▲	THT-140-488-3	0.900 (22.86)	0.750 (19.05)		3,000	R4301	R4306	F A S P G
▲	THT-141-488-3	0.900 (22.86)	0.900 (22.86)		3,000	R4301	R4306	F A S P G
▲	THT-164-488-1	0.900 (22.86)	0.900 (22.86)		1,000	R4301	R4306	F A S P G
▶	THT-10-427-3	1.000 (25.40)	3.750 (95.25)	1.000 (25.40)	3,000	R4301	R4300	F N S V S P G

### WELL PLATE LABELS

Diagram	Part Number	Label Width A Inch (mm)	Label Height B Inch (mm)	Labels/ Roll	BP1344 Model Ribbon	200/300MVP, 600X, 6441 Ribbon	Special Properties
▲	THT-15-423-2.5	2.000 (50.80)	0.250 (6.35)	2,500	R6001	R6000	F A P G
▲	THT-151-499-3	2.000 (50.80)	0.250 (6.35)	3,000	R4301	R4302	F N A V P G
▲	THT-142-423-2.5	2.500 (63.50)	0.200 (5.08)	2,500	R6001	R6002	F A P G

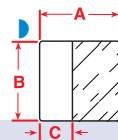

### STRAW LABELS

Diagram	Part Number	Label Width A Inch (mm)	Label Height B Inch (mm)	Write-On Area/ Diameter C Inch (mm)	Labels/ Roll	BP1344 Model Ribbon	200/300MVP, 600X, 6441 Ribbon	Special Properties
▶	THT-116-427-5	1.000 (25.40)	1.000 (25.40)	0.375 (9.53)	5,000	R4301	R4302	F N S V

\* The label is all white.

### BOTTLE TAMPER SEAL LABELS

Diagram	Part Number	Label Width A Inch (mm)	Label Height B Inch (mm)	Labels/ Roll	BP1344 Model Ribbon	200/300MVP, 600X, 6441 Ribbon	Special Properties
▲	THT-5-351-10	1.000 (25.40)	0.500 (12.70)	10,000	R6201	R6202	F P G
▲	THT-17-351-3	2.000 (50.80)	1.000 (25.40)	3,000	R6201	R6200	F P G

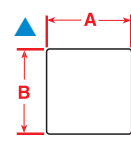

## Laser Printer Labels

### LASER PRINTERS

Brady's durable lab labels are available for use in your office laser printer. Use Brady IdentiLab™ software or BradySoft™ 8 software to create your labels (sold separately on p. 19).

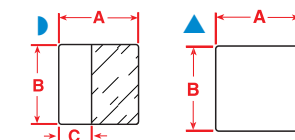

### CENTRIFUGE / EPPENDORF / PCR TUBE LABELS

Diagram	Part Number	Label Width A Inch (mm)	Label Height B Inch (mm)	Write-On Area/ Diameter C Inch (mm)	Pieces/ Package	Labels/ Sheet	Special Properties
<b>0.5 TO 0.7ml TUBE</b>							
▲	LAT-40-799-1	0.500 (12.70)	0.750 (19.05)		1,000	156	F N A V P G
▲	LAT-8-799-10	1.000 (25.40)	0.375 (9.53)		10,000	175	F N A V P G
▶	LAT-57-361-2.5	0.375 (9.53)	1.800 (45.72)	0.750 (19.05)	2,500	100	F N A H S L V
<b>1.2 TO 2.0ml TUBE</b>							
▶	LAT-56-361-2.5	0.600 (15.24)	1.625 (41.28)	1.000 (25.40)	2,500	64	F N A H S L V
▶	LAT-59-361-2.5	0.600 (15.24)	2.625 (66.68)	1.000 (25.40)	2,500	64	F N A H S L V

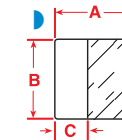

### VIAL / TUBE LABELS

Diagram	Part Number	Label Width A Inch (mm)	Label Height B Inch (mm)	Write-On Area/ Diameter C Inch (mm)	Pieces/ Package	Labels/ Sheets	Special Properties
<b>1.0 - 8.0ml VIAL / TUBE</b>							
▶	LAT-59-361-2.5	0.600 (15.24)	2.625 (66.68)	1.000 (25.40)	2,500	45	F N A H S L V
▶	LAT-58-361-1	1.000 (25.40)	2.625 (66.68)	1.000 (25.40)	1,000	21	F N A H S L V

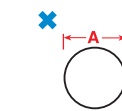

### VIAL TOP LABELS

Diagram	Part Number	Diameter A Inch (mm)	Pieces/ Package	Labels/ Sheets	Special Properties
<b>0.6 - 1.5ml VIAL / TUBE</b>					
*	LAT-60-799-2.5	1.000 (25.40)	2,500	285	F N A V P G
<b>1.0 - 2.0ml VIAL / TUBE</b>					
*	LAT-61-799-2.5	0.500 (12.70)	2,500	192	F N A V P G

### CONICAL / BOTTLE / PETRI DISH / DEEP WELL PLATE LABELS

Diagram	Part Number	Label Width A Inch (mm)	Label Height B Inch (mm)	Pieces/ Package	Labels/ Sheets	Special Properties
<b>50.0ml CONICAL TUBE / BOTTLES / PETRI DISH / DEEP WELL PLATE</b>						
▲	LAT-7-709-10	1.000 (25.40)	0.500 (12.70)	10,000	133	F A R P G
▲	LAT-39-799-2.5	1.000 (25.40)	1.437 (36.50)	2,500	42	F N A V P G

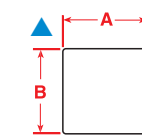

### WELL PLATE LABELS

Diagram	Part Number	Diameter A Inch (mm)	Label Height B Inch (mm)	Pieces/ Package	Labels/ Sheet	Special Properties
▲	LAT-10-747-10	1.875 (47.63)	0.250 (6.35)	10,000	156	F A P G

## FreezerBondz™ Labels

- F** Freezer environment
- N** Liquid nitrogen environment
- A** Autoclave environment
- H** Hot water (100°C) bath
- S** Self-laminating label
- L** Low-profile (extremely thin) label
- R** Removable/Repositionable

- V** Vial identification
- S** Slide identification
- P** Plate identification
- G** General identification

FreezerBondz™ labels can withstand environments from LN2 to autoclave, helping to preserve your research while maintaining traceability of your samples.

- Survives exposure to common laboratory environments, such as liquid nitrogen, freezer (-196°C), autoclave, and water baths up to 121°C
- Label sizes are available for vials, slides, well plates, straws, petri dishes, boxes, and general applications



### B-492 LABELS FOR LABXPRT™ AND BENCHTOP THT PRINTERS

Part Number	Label Size W x H (inches)	Label Size W x H (mm)	Qty. Per Package	Targeted Vial Size	Special Properties
<b>BENCHTOP THT</b>					
THT-152-492-3	1.00 x 0.375	25.4 x 9.525	3,000	x	F N A H L V P G
THT-59-492-10	1.00 x 0.500	25.4 x 12.7	10,000	x	F N A H L V P G
THT-179-492-3	1.00 x 1.000	25.4 x 25.4	3,000	x	F N A H L V P G
THT-180-492-3	0.90 x 1.000	22.86 x 25.4	3,000	1.0-8.0 ml	F N A H L V P G
THT-156-492-3	1.90 x 1.000	48.26 x 25.4	3,000	2.0 ml	F N A H L V P G
THT-143-492-3	0.375 diameter	9.525 diameter	3,000	0.5-0.7 ml	F N A H L V P G
THT-144-492-3	0.500 diameter	12.7 diameter	3,000	x	F N A H L V P G
THT-163-492-3	.375 diameter w/ 1.00 x .375 label	9.525 diameter w/ 25.4 x 9.525 label	3,000	0.5-0.7 ml	F N A H L V P G
THT-181-492-3	.375 diameter w/ 1.00 x .500 label	9.525 diameter w/ 25.4 x 12.7 label	3,000	0.5-0.7 ml	F N A H L V P G
THT-182-492-3	.44 diameter w/ 1.00 x .500 label	11.76 diameter w/ 25.4 x 12.7 label	3,000	x	F N A H L V P G
<b>LABXPRT</b>					
X-130-492	0.375 x 0.825	9.53	275	0.5-0.7 ml	F N A H L V P G
X-131-492	0.500 x 1.000	12.70 x 25.40	225	1.0-8.0 ml	F N A H L V P G
X-156-492	0.900 x 1.000	22.86 x 25.40	225	1.0-8.0 ml	F N A H L V P G
X-78-492	1.000 x 1.900	25.40 x 48.20	125	12.0-50.0 ml	F N A H L V P G
X-117-492	0.500 x 1.000 x 0.440 diameter		300	1.0-2.0 ml	F N A H L V P G
X-118-492	0.375 x 1.000 x 0.375 diameter		300	0.5-0.7 ml	F N A H L V P G
X-120-492	0.500 x 1.000 x 0.440 diameter		300	1.0-2.0 ml	F N A H L V P G
X-92-492	0.375 diameter	9.53	300	vial tops	F N A H L V P G
X-83-492	0.500 diameter	12.70	300	vial tops	F N A H L V P G
X-155-492	0.250 x 1.250	6.35 x 31.75	400	cane, tops	F N A H L V P G
XC-500-492	0.500 x 30 ft	12.70 x 9.10 m	1 roll	misc. uses	F N A H L V P G

### B-490 LABELS FOR TLS 2200 AND PC LINK

Part Number	Label Size W x H (inches)	Label Size W x H (mm)	Qty. Per Package	Targeted Vial Size	Special Properties
PTL-112-490	1.250 x 0.375	31.75 x 9.53	500	0.6 ml	F N A H L S P G
PTL-76-490	1.625 x 0.600	41.28 x 15.24	250	1.5 ml	F N A H L S P G
PTL-78-490	1.900 x 1.000	48.26 x 25.40	250	2.0 ml	F N A H L S P G
PTL-113-490	2.200 x 1.500	55.88 x 38.10	100	15 ml	F N A H L S P G
PTL-114-490	3.750 x 1.500	95.25 x 38.10	100	50 ml	F N A H L S P G

## Label Creation Software



Part Number	Version
BS80ULTM	BradySoft™ 8 Ultimate RFID
BS80STD	BradySoft™ 8 Standard
BS80ULTM	BradySoft™ 8 Network 3

### BRADYSOFT™ 8 LABEL DESIGN SOFTWARE

BRADYSOFT™ 8 Label Design Software is a powerful labelling program that helps your organization manage assets and resources, control distribution channels and stock levels, track documents, or manage data records – all in one scalable solution.

BRADYSOFT™ software has applications to provide for advanced label design, user access and control, data management, automated printing and product tracking.

#### Server Requirements: Hardware Requirements:

IBM compatible PC (486 or higher), 64 MB RAM for Windows® 2000 or Windows® XP users (128 MB recommended), 256 MB RAM for Windows® Server 2003 users (512 MB RAM recommended), SVGA monitor or better, Hard Drive with 150 MB free space or greater, CD ROM drive.

#### Operating System and System Files:

Microsoft® Windows® 2000, Windows® XP or Windows® Server 2003, Microsoft® Data Access Components 2.8 (MDAC) or greater, Microsoft® .Net Framework 1.1.

#### Application Requirements:

Microsoft® Internet Explorer 6.0 or greater, Adobe Acrobat Reader 6.0 or greater.



Part Number	Version
IDL	IdentiLab software, single user
IDL-SITE	IdentiLab software site license (for 4+ users)

### IDENTILAB™ LABORATORY LABELLING SOFTWARE

Created for lab users, IDENTILAB™ software features a lab-friendly interface and hundreds of parts and graphics categorized by common lab applications making creating legible, durable, and accurate labels quick and easy.

- Easy-to-use wizards to create new files and templates
- Superscript and subscript characters
- Database import capabilities with refresh feature to ensure data integrity
- 2D bar coding and linear bar coding
- Multi-label data entry view
- Compatibility with a variety of Brady printers including LABXPRT™, TLS 2200®, TLS-PC LINK™, all BRADYPRINTER™ benchtop thermal transfer models and all Windows®-based printers

#### System Requirements

Pentium® Processor  
 Windows® 9x/ME/2000/NT/XP  
 Internet Explorer 5.01  
 64 MB of RAM (minimum 16 MB of RAM)  
 100 MB of available hard disk space  
 16-Bit or greater video display card  
 800 x 600 or greater monitor resolution  
 CD-ROM drive

# OTHER BRADY LABORATORY PRODUCTS

## SORBENTS & SPILL CONTROL

The range and quantity of hazardous substances used in laboratories requires careful pre-planning to respond safely to chemical spills. Be prepared with Brady's Chemical range of Sorbents and Spill Control products.



Chemical Spill Control Pads



Chemical Spill Kaddy



Chemical Spill Kit

## SAFETY SIGNS

Brady offers a large range of safety signs suitable for all laboratory requirements.



SAFETY GOGGLES  
MUST BE WORN  
IN THIS AREA



PROTECTIVE CLOTHING  
MUST BE WORN  
IN THIS AREA

Mandatory Signs



RADIATION  
HAZARD



AUTHORISED  
PERSONNEL ONLY



CORROSIVE



HAND  
PROTECTION  
MUST BE WORN

Multiple Warning Signs



EMERGENCY SHOWER  
AND EYE WASH  
IN CASE OF CHEMICAL SPILL WASH FOR 15  
MINUTES PRIOR TO MEDICAL TREATMENT



EMERGENCY  
IF YOU COME IN CONTACT  
WITH CORROSIVE CHEMICALS  
GET UNDER  
A SHOWER IMMEDIATELY  
- SECONDS COUNT -  
LARGE VOLUMES OF WATER  
ARE NECESSARY

Emergency Information Signs

## FIRST AID KITS

Be prepared for any emergency with Brady's range of First Aid Kits. We have kits to suit any size laboratory. Our kits comply with appropriate State workplace codes and legislation.



Workplace Portable 1



Workplace Wall Mount 1



Workplace Wall Mount 2

For more information about Brady's wide range of safety and facility solutions, please visit our website [www.bradyaust.com.au](http://www.bradyaust.com.au) to request a FREE Catalogue.

[WWW.BRADYID.COM/LAB](http://WWW.BRADYID.COM/LAB)

[WWW.LABELSANDPRINTERS.COM.AU](http://WWW.LABELSANDPRINTERS.COM.AU)



Y94202

© 2008 Brady Worldwide, Inc. All Rights Reserved.  
11-08-MW MS94202

Brady Australia Pty Ltd

PO Box 435  
Regents Park Estate BC NSW 2143

S4-S6 Regents Park Estate  
391 Park Road  
Regents Park NSW 2143

Free Call: 1-800-620-816



**BRADY**  
WHEN PERFORMANCE MATTERS MOST™